



THIS SHEET IS FOR INFORMATIONAL PURPOSES ONLY. ANY UPDATES AND CHANGES MAY NOT BE INDICATED. THE HOME WILL BE CONSTRUCTED PER CUSTOMER APPROVED PLAN AND SPECIFICATION SHEETS. ALL AVAILABLE OPTIONS AND FEATURES MAY NOT BE DEPICTED. PLEASE CONTACT A SALES REPRESENTATIVE FOR MORE INFORMATION.



Front



Right



Rear



Left

METRO MANOR PLAN DATA

Interior Area (1862 sq ft)

Main Level 931 sq ft

Upper Level 931 sq ft

Living Area (1959 sq ft)

Main Level 1002 sq ft

Upper Level 957 sq ft

Main Level Wall Height: 10'-1"

Upper Level Wall Height: 8'-1"

Width 25 ft

Depth 42 ft

Bedrooms 3

Full Bath 2-Up

Half Bath 1-Main

Garage 20'x20' Detached 2 car

Interior Area includes all conditioned area inside of exterior finished walls & interior wall footprints. Includes Stair Opening areas.

Living Area includes footprints of all framed interior & exterior walls containing conditioned space plus half the wall footprint between conditioned and unconditioned spaces. Includes area of 1st Floor Stair Opening.



B. R. Knez Construction, Inc.
7555 Fredle Drive - Suite 210
Concord Township, OH 44077
(440)710-0711 Fax: 639-6485
www.knez.net



Metro Manor Elevations
Standard Plan



Building
Customers
for Life

SHEET
1

Metro Series Plans

NOTE: This floorplan is the exclusive property of B.R. Knez Construction, Inc. and may not be duplicated or modified in any way without the expressed permission of the company. Some optional features may be shown. Actual homes constructed per agreed upon plan and specification sheet.



THIS SHEET IS FOR INFORMATIONAL PURPOSES ONLY. ANY UPDATES AND CHANGES MAY NOT BE INDICATED. THE HOME WILL BE CONSTRUCTED PER CUSTOMER APPROVED PLAN AND SPECIFICATION SHEETS. ALL AVAILABLE OPTIONS AND FEATURES MAY NOT BE DEPICTED. PLEASE CONTACT A SALES REPRESENTATIVE FOR MORE INFORMATION.

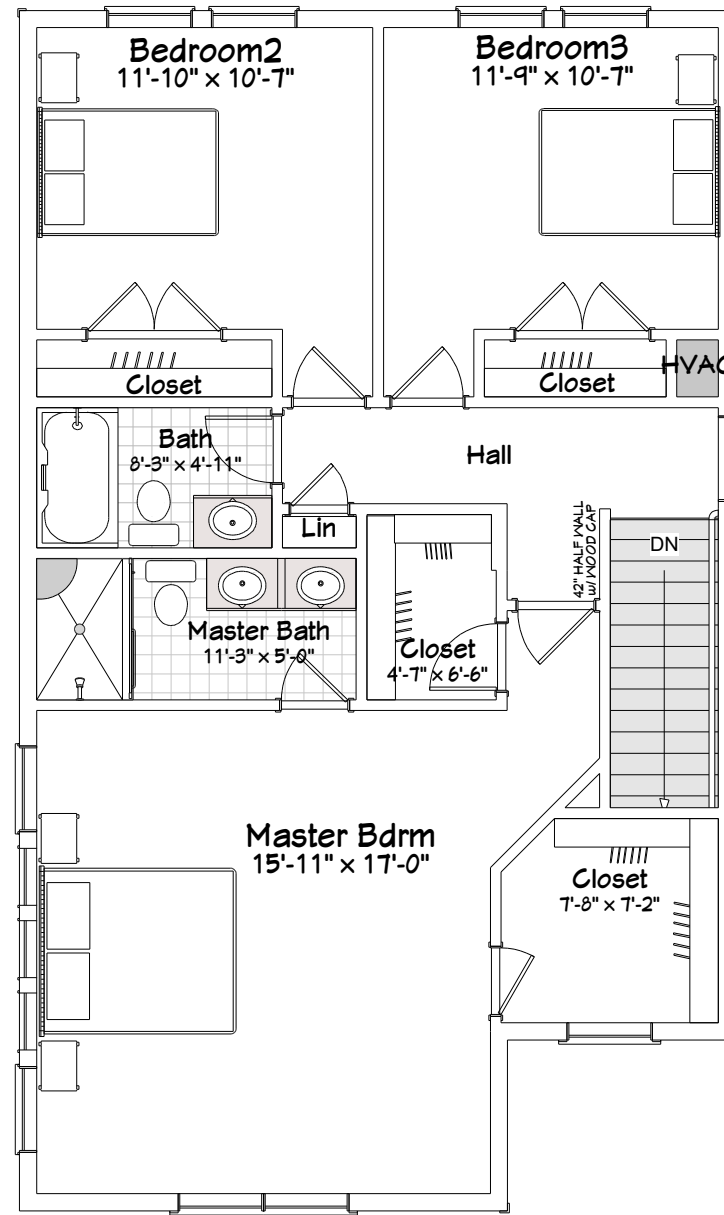
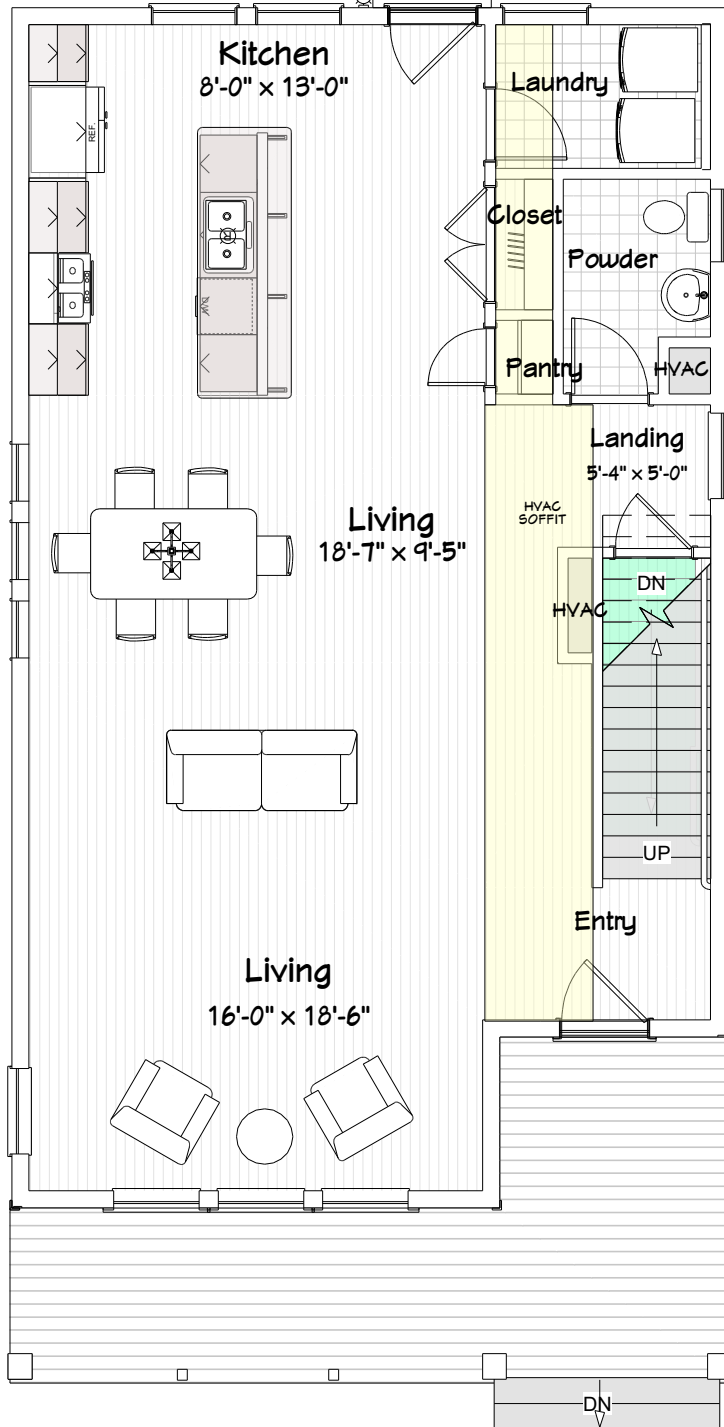

B. R. Knez Construction, Inc.
7555 Fredle Drive - Suite 210
Concord Township, OH 44077
(440)710-0711 Fax: 639-6485
www.knez.net



Metro Manor Plan
Standard Plan



Building Customers for Life

SHEET
2
7/14/2017

Metro Series Plans

NOTE: This floorplan is the exclusive property of B.R. Knez Construction, Inc. and may not be duplicated or modified in any way without the expressed permission of the company. Some optional features may be shown. Actual homes constructed per agreed upon plan and specification sheet.